

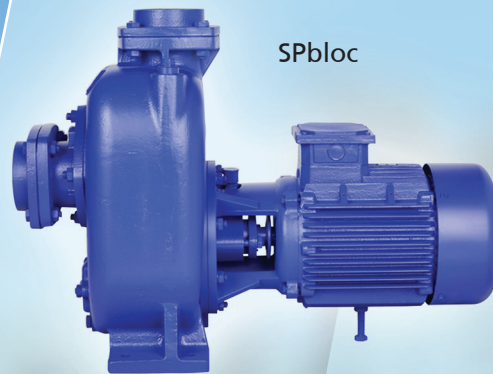

## SPnorm & SPbloc Self Priming Centrifugal Pumps

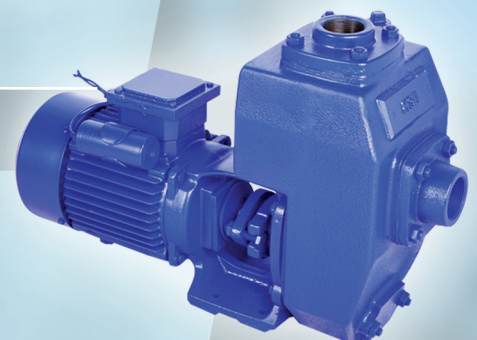

SPbloc



SPbloc



SPnorm



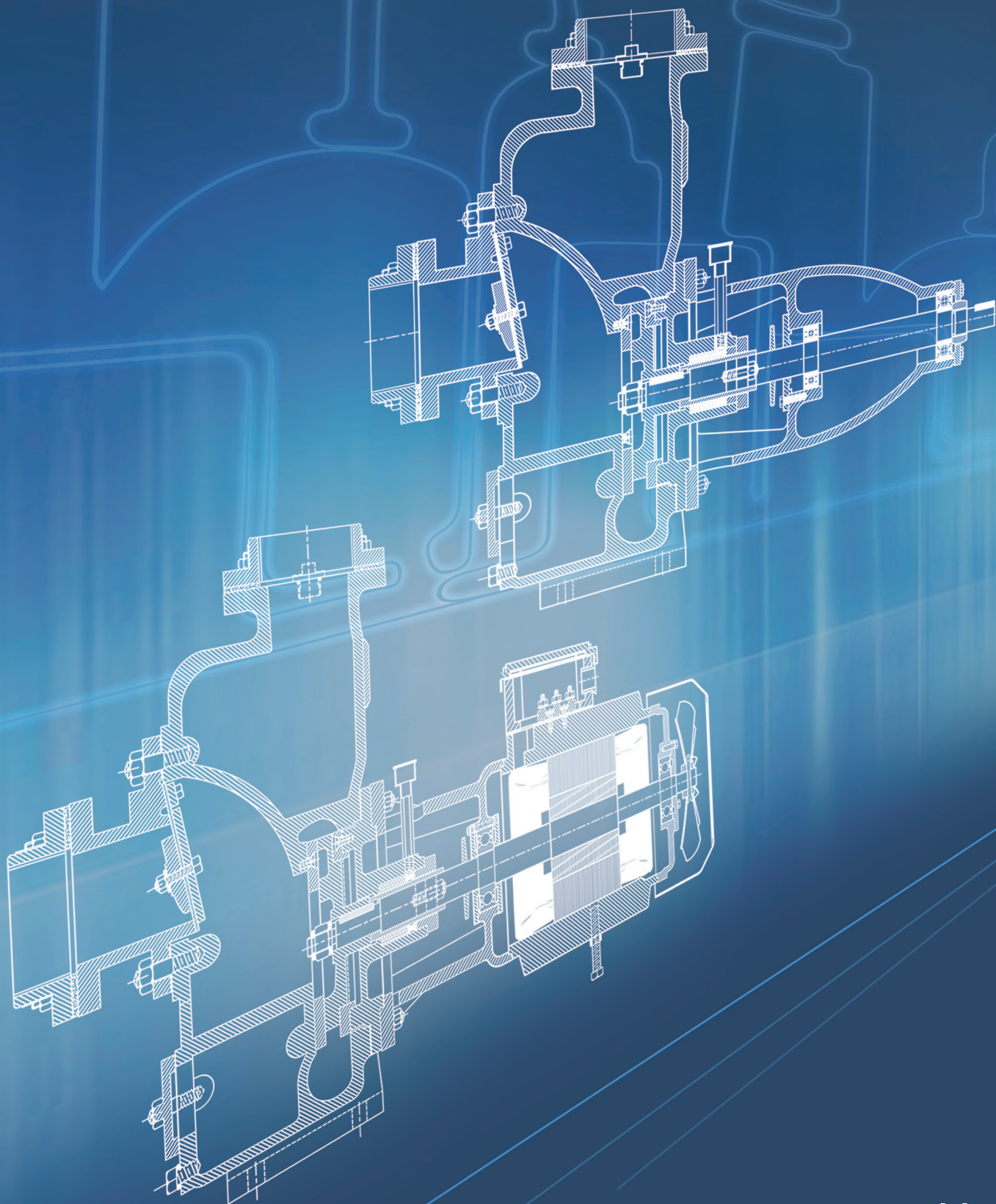

**SPnorm & SPbloc**  
Self Priming Centrifugal Pumps

# SPnorm & SPbloc - Self Priming Centrifugal Pumps



## Design

### SPnorm:

Horizontal self priming volute casing pumps, single stage with semi open impeller, in back pull out design. Long coupled on baseplate, suction lift up to 7 metres.

Technical specifications conforms to **IS 8472 & IS 8418.**

Performance Testing as per **IS 11346.**

### SPbloc:

Horizontal self priming volute casing pumps, single stage with semi open impeller, in back pull out design. Monobloc, mono shaft design, hydraulics are assembled on extended motor shaft, suction lift up to 7 metres.

Technical specifications conforms to **IS 8472 & IS 8418.**

Performance Testing as per **IS 11346.**

## Applications

- Suitable for pumping muddy water, sewage, polluted liquids including solids etc.
- For de-watering at Basements, Trenches, Swimming pools and Construction sites.
- For handling liquid cargos from ship or plane.
- Useful in tiles and marble factories for handling waste liquids.
- For Salvage operations such as saving ship or cargo, fire fighting etc.
- Any application where priming and foot valve is to be avoided.

## Industry wise Applications:



**Industrial:** Pumping petroleum products, chemicals, effluents, Sewage, ash-water etc



**Mobile Machinery:** Cooling water for marine engines & showels.



**Tiles & Marble industry:** for handling waste water.



**Civil Construction:** De-watering foundation, trenches and pits.



**Public utilities:** Sewage pumping.



**Marine:** Pumping water from docks, ports, vessels.

## Technical Data

		SPbloc (monobloc)	SPnorm (barepump)
Head	m	6 to 36	6 to 50
Capacity	LPS	up to 19.4	up to 71
	m <sup>3</sup> /hr	up to 70	up to 253
Power rating	HP	1 to 7.5	1 to 25
	kW	0.75 to 5.5	0.75 to 18.5
DN size		DN 40, 50, 80	DN 40, 50, 80, 100, 150
MOC	Pump body	C.I.	C.I., SS
	Motor body	C.I.	-
	Impeller	C.I., SS, Bronze	C.I., SS, Bronze
	Wear plate	C.I., SS	C.I., SS
	Shaft	SS 410	SS 410, 316, 304
	Shaft sleeve	SS 410	SS 410, 316, 304
Sealing		Gland packing or mechanical seal	Gland packing or mechanical seal
Driver			Motor or Engine



SPbloc



SPnorm





## Cross Sectional View - SPnorm 14 (Reference Drawing)

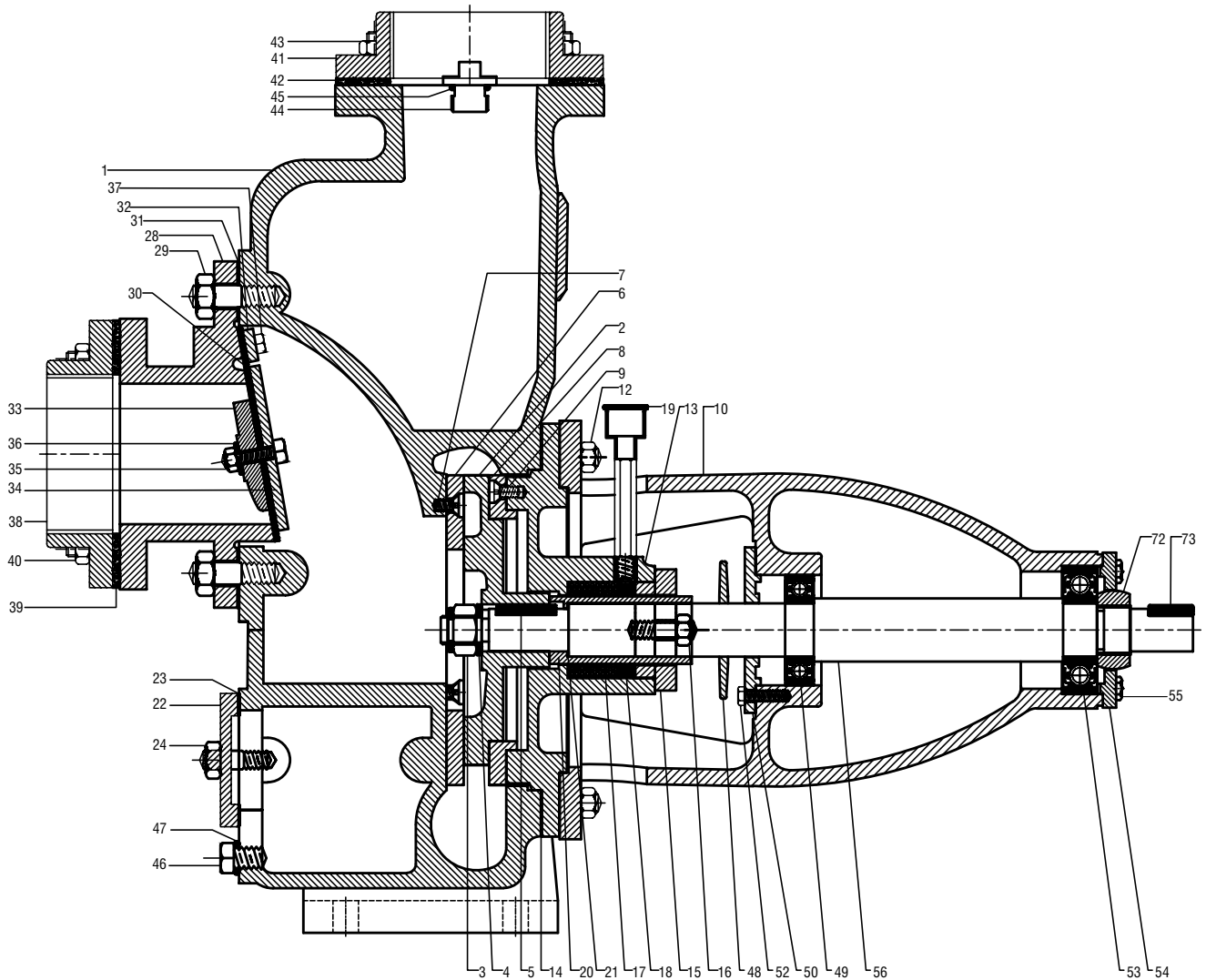

29	Stud with Nut for Suction housing	4	M.S.
28	Suction Housing	1	C.I. Gr. FG-260
24	Stud with Nut for Insp. window cover	2	M.S.
23	Packing for Insp. window cover	1	Paper
22	Insp window cover	1	C.I. Gr. FG-260
21	Gasket	1	Paper
20	Shaft Sleeve	1	S.S. Gr. AISI410
19	Grease Cup with Pipe Nipple	1	M.S.
18	Lantern ring	1	Plastic
17	Gland Packing	1 Set	Graphite Asbestos
16	Hex. bolt or Stud with Nut for Gland cover	2	M.S.
15	Gland Cover	1	C.I. Gr. FG-260
14	Packing for Stuffing Box Housing	1	Paper
13	Stuffing Box Housing	1	C.I. Gr. FG-260
12	Stud with Nut for Brg. housing & St. box housing	8	M.S.
11	Packing for Bearing housing	3	Paper
10	Bearing Housing	1	C.I. Gr. FG-260
9	Counter Sunk Screw for Wearing Plate	3	S.S. Gr. AISI304
8	Wearing Plate (DE)	1	C.I. Gr. FG-260
7	Counter Sunk Screw for Wearing Plate	3	S.S. Gr. AISI304
6	Wearing Plate (NDE)	1	C.I. Gr. FG-260
5	Key for Impeller Nut	1	M.S.
4	Washer for Impeller Nut	1	M.S.
3	Impeller Nut	1	M.S.
2	Impeller	1	C.I. Gr. FG-260
1	Pump Body	1	C.I. Gr. FG-260
<b>Part no</b>	<b>Part Description</b>	<b>Qty</b>	<b>Material</b>

73	Key for Coupling	1	M.S.
72	Bearing Lock Nut	1	M.S.
56	Rotar Shaft	1	CRNO Gr. M-47 & EN-8D
55	Cheese Head Screw for Bearing cover (DE side)	4	M.S.
54	Bearing Cover (DE side)	1	C.I. Gr. FG-260
53	Bearing (DE side)	1	Steel
52	Cheese Head Screw for Bearing cover (NDE side)	3	M.S.
50	Bearing Cover (NDE side)	1	C.I. Gr. FG-260
49	Bearing (NDE side)	1	Steel
48	Water Deflector	1	Rubber
47	O-Ring for Drain Plug	1	Rubber
46	Drain Plug	1	C.I. Gr. FG-260
45	O-Ring for Water Plug	1	Rubber
44	Water Plug (for Priming)	1	C.I. Gr. FG-260
43	Stud with Nut for Delivery flange	4	M.S.
42	Packing for Delivery flange	1	Rubber
41	Delivery flange	1	C.I. Gr. FG-260
40	Stud with Nut for Suction flange	4	M.S.
39	Packing Suction Flange	1	Rubber
38	Suction Flange	1	C.I. Gr. FG-260
37	Cheese Head Screw for Wt. fixing	2	M.S.
36	Washer for Flap valve	1	M.S.
35	Hex. bolt with Nut for Flap valve	1	M.S.
34	Weight for Flap valve (big)	1	C.I. Gr. FG-260
33	Weight for Flap valve (medium)	1	C.I. Gr. FG-260
32	Weight for Flap valve (Small)	1	C.I. Gr. FG-260
30	Flap valve	1	Nitril Rubber
<b>Part no</b>	<b>Part Description</b>	<b>Qty</b>	<b>Material</b>

## Cross Sectional View - SPbloc 14M (Reference Drawing)

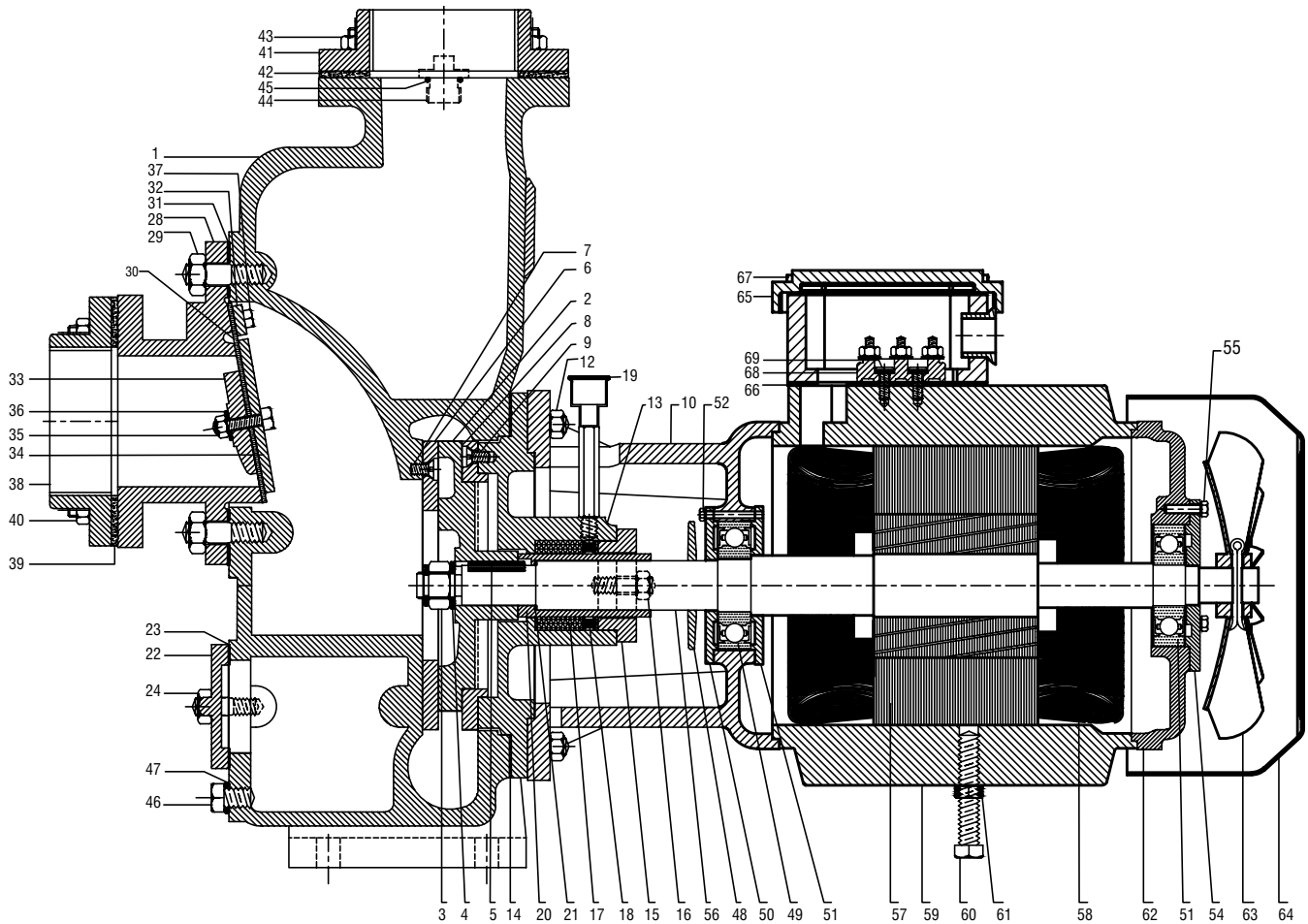

37	Cheese Head Screw for Wt. fixing	2	M.S
36	Washer for Flap valve	1	M.S.
35	Hex. bolt with Nut for Flap valve	1	M.S.
34	Weight for Flap valve (big)	1	C.I. Gr. FG-260
33	Weight for Flap valve (Medium)	1	C.I. Gr. FG-260
32	Weight for Flap valve (Small)	1	C.I. Gr. FG-260
31	Packing for Flap valve	1	Paper
30	Flap valve	1	Nitril Rubber
29	Stud with Nut for Suction housing	4	M.S.
28	Suction Housing	1	C.I. Gr. FG-260
24	Stud with Nut for Insp. window cover	2	M.S.
23	Packing for Insp. window cover	1	Paper
22	Insp window cover	1	C.I. Gr. FG-260
21	Gasket	1	Paper
20	Shaft Sleeve	1	S.S. Gr. AISI410
19	Grease Cup with Pipe Nipple	1	M.S.
18	Lantern ring	1	Plastic
17	Gland Packing	1 Set	Graphite Asbestos
16	Hex. bolt or Stud with Nut for Gland cover	2	M.S.
15	Gland Cover	1	C.I. Gr. FG-260
14	Packing for Stuffing Box Housing	1	Paper
13	Stuffing Box Housing	1	C.I. Gr. FG-260
12	Stud with Nut for Brg. housing & St. box housing	8	M.S.
10	Bearing Housing	1	C.I. Gr. FG-260
9	Counter Sunk Screw for Wearing Plate	1	S.S. Gr. AISI304
8	Wearing Plate (DE)	1	C.I. Gr. FG-260
7	Counter Sunk Screw for Wearing Plate	3	S.S. Gr. AISI304
6	Wearing Plate (NDE)	1	C.I. Gr. FG-260
5	Key for Impeller Nut	1	M.S.
4	Washer for Impeller Nut	1	M.S.
3	Impeller Nut	1	M.S.
2	Impeller	1	C.I. Gr. FG-260
1	Pump Body	1	C.I. Gr. FG-260
<b>Part No.</b>	<b>Description</b>	<b>Qty</b>	<b>Material</b>

69	Cheese Head Screw for Terminal	4	M.S.
68	Terminal	1	Bakelite
67	Cheese Head Screw for Terminal Box	4	M.S.
66	Packing for Terminal Box	1	Rubber
65	Terminal Box	1	C.I. or M.S. Sheet
64	Fan Cover	1	M.S. Sheet
63	Fan Cover	1	Plastic
62	End Cover	1	C.I. Gr. FG-260
61	Washer for Motor Adjustment Bolt	1	M.S.
60	Motor Adjustment Bolt	1	M.S.
59	Motor Body	1	C.I. Gr. FG-260
58	Stator Winding	1	Copper
57	Stator	1	CRNO Gr. M-47
56	Rotor Shaft	1	CRNO Gr. M-47 & EN-8D
55	Cheese Head Screw for Bearing cover (DE side)	4	M.S
54	Bearing Cover (DE side)	1	C.I. Gr. FG-260
53	Bearing (DE side)	1	Steel
52	Cheese Head Screw for Bearing cover (NDE side)	4	M.S
51	Bearing Cover (In Side)	1	C.I. Gr. FG-260
50	Bearing Cover ( Out side)	1	C.I. Gr. FG-260
49	Bearing (NDE side)	1	Steel
48	Water Deflector	1	Rubber
47	O-Ring for Drain Plug	1	Rubber
46	Drain Plug	1	C.I. Gr. FG-260
45	O-Ring for Water Plug	1	Rubber
44	Water Plug (for Priming)	1	C.I. Gr. FG-260
43	Stud with Nut for Delivery flange	4	M.S.
42	Packing for Delivery flange	1	Rubber
41	Delivery flange	1	C.I. Gr. FG-260
40	Stud with Nut for Suction flange	4	M.S
39	Packing Suction Flange	1	Rubber
38	Suction Flange	1	C.I. Gr. FG-260
<b>Part No.</b>	<b>Description</b>	<b>Qty</b>	<b>Material</b>

## Manufacturing Plants :

**Head Office & Pimpri :**  
Irrigation & Process Division  
Mumbai-Pune Road, Pimpri,  
Pune - 411 018.  
Tel.: 020-2710 1000

### Chinchwad :

**Power Projects Division**  
D-II Block, MIDC Chinchwad,  
Pune - 411 019.  
Tel.: 020-2740 9100

### Khandala :

**Energy Pumps Division**  
A1, MIDC Khandala Phase II,  
Village Kesurdi, Tal. Khandala,  
Satara - 412 802.  
Tel. : 02169 -246800

### Coimbatore :

**Valves Division**  
151, Mettupalayam Road,  
NSN Palayam Post,  
Coimbatore - 641 031.  
Tel.: 0422-2468222, 2468547-9

### Sinnar :

**Standard Pumps Division**  
Plot No. E-3 & E-4, MIDC Sinnar,  
Nashik - 422 113.  
Tel.: 02551-230252 / 53, 229700

### Vambori :

**Foundry Division**  
Vambori, Ahmednagar - 413 704.  
Tel.: 02426-272534, 272550, 272463

### Regd. Office :

Office No. 601, Runwal R-Square,  
L.B.S. Marg, Mulund (West),  
Mumbai- 400 080,  
Tel.: 022-6658 8787

### Zonal Offices :

#### East :

30, Circus Avenue, 2nd Floor,  
Kolkata - 700 017.  
Tel.: 033-2287 0473, 2290 0117

#### West :

Office No. 601, Runwal R-Square,  
L.B.S. Marg, Mulund (West),  
Mumbai- 400 080  
Tel.: 022-6658 8787

#### North :

KSB House, A-96, Sector IV, NOIDA,  
Dist. Gautam Budh Nagar - 201 301.  
Tel.: 0120-2471 600 Fax : 0120-255 0567

#### South :

Guindy House, II Floor, # 92 Anna Salai,  
Chennai - 600 032.  
Tel.: 044-2235 2571-2, 2235 5673  
Fax : 044-2235 2749

## Service Stations :

### Chennai :

# 6, Self-help Industrial Estate,  
Keelkattalai, Near Keelkattalai -  
Pallavaram Radial Road Signal junction,  
Chennai 600 117  
Tel. 044-22681159

### Howrah :

Sadananda Industrial Estate  
Howrah Amta Road, Balitikuri,  
Bakultala Howrah - 711 113, West Bengal

### NOIDA :

KSB House, A-96, Sector IV, NOIDA,  
Dist. Gautam Budh Nagar - 201 301.  
Tel.: 0120-2471 600  
Fax : 0120-255 0567

### Odhav :

Shed No. 22, Gujarat Vepari  
Mahamandal, Odhav,  
Ahmedabad - 382 410.  
Tel.: 079-2290 0372  
Fax : 079-2290 0749

### Chinchwad :

D-II Block, MIDC Chinchwad,  
Pune - 411 019.  
Tel.: 020-2740 9100 Fax : 020-2747 0890

### Baddi:

Plot No. 73, DIC Industrial Area, Baddi,  
Distt. Solan, Himachal Pradesh -173 205  
Tel. : +91 98764 12714

## Branch Offices :

### Bangalore :

2nd Floor, Plot No. 69/A,  
Service Road, WOC Road, II Stage,  
Bengaluru - 560 086.  
Tel.: 080-2349 1806, 2349 3925

### Baroda :

4-B, Ramkrishna Chamber,  
Productivity Road, Baroda - 390 005.  
Tel.: 0265-233 0532, 233 3226  
Fax : 0265-235 0002

### Bhubaneswar :

N5/39,1st Floor, IRC Village, Nayapalli,  
Bhubaneswar - 751 015.  
Tel.: 0674-255 8497  
Fax : 0674-255 8499

### Chandigarh :

SCO - 189, 2nd Floor, Sector - 7C,  
Chandigarh - 160 019.  
Tel. / Fax : 0172-279 0072, 279 0062

### Guwahati :

House No 41, Apro Colony Road,  
Ulubari, Guwahati- 781007, Assam  
Tel : 96744 77971, 86381 10620

### Indore :

Office No 104, 1st Floor, Fortune  
Ambience, 4/2 South Tukogunj  
Indore - 452001  
Tel.: 0731- 4216704, 4216705

### Jaipur :

Anjali Chambers, 2nd Floor, Block C,  
10, Rajbhawan Road, Civil Lines,  
Jaipur - 302 001.  
Tel.: 0141-222 4554, 222 4904  
Fax : 0141-222 4904

### Jamshedpur :

Flat No: 3/1, 3rd Floor, Plot No: 20,  
Road No: 2, Sonari West Layout,  
Jamshedpur - 831011.  
Tel.: 0657-231 4012, 231 4011  
Fax : 0657-231 7128

### Lucknow :

309, Chintels House, 16, Station Road,  
Lucknow - 226 001.  
Tel.: 0522-263 5203, 263 5597  
Fax : 0522-263 5597

### Patna :

3rd Floor, Suraj Complex, Sahyogi Press  
Lane, Exhibition Road, Patna - 800 001.  
Tel.: 70336 80790

### Pune :

Mumbai-Pune Road, Pimpri,  
Pune - 411 018.  
Tel.: 020-2710 1000 Fax : 020-2742 6000

### Raipur :

1st floor, E-5, Sector-5, Devender Nagar,  
Raipur, Chhattisgarh - 492009  
Tel.: 0771-258 3658, 258 3921  
Fax : 0771-258 3921

### Secunderabad :

D. No. 12-13-197, 198,  
Flat No. 103 & 104, 1st Floor,  
Pavani Anusuya Towers, Tarnaka,  
Secunderabad - 500 017.  
Tel.: 040-2700 1724, 2700 3696  
Fax : 040-2700 1725

### Ernakulam (Kochi) :

Ground Floor, D/No 22/241 (S),  
Tamrind Rajadhani, Pulinchode, Aluva  
Ernakulam - 683 101 (India)  
Tel : 62353 55500

### Dhaka (Bangladesh)

Level - 08, Locus Coworking Space, Tower  
52, Plot-52, Block- C, Road-11, Banani, Dha-  
ka -1213 (Bangladesh)  
Tel.: +880 17677 02914